

St. Johns County Board of County Commissioners

LAND MANAGEMENT SYSTEMS
REAL ESTATE DIVISION

4020 Lewis Speedway
SAINT AUGUSTINE, FLORIDA
32084



PHONE: (904) 209-0796
FAX: (904) 209-0797
E-MAIL: dtaylor@co.st-johns.fl.us

April 11, 2007

D.R. Horton, Inc.
Attn: Bob Porter
9456 Philips Hwy. Ste. 1
Jacksonville, FL 32256

Dear Bob,

St. Johns County is in the process of developing plans to do improvements along SR16 in your area. The improvements the County would like to do would be, soften the curve, add turning lanes, align the two development roads, Silver Glen Avenue and Hunters Lane, and permit access off of SR16 into Heritage Landing. I have enclosed a map showing in color the areas needed for this project. The County will need to acquire .3 acres of property from you, which is shown in yellow and pink and labeled as Acquisition No. 3 & 4.

Please review the enclosed map and call me with any questions or concerns. I look forward in meeting with you and working together on this project.

Sincerely,

Debbie Taylor
Real Estate Coordinator

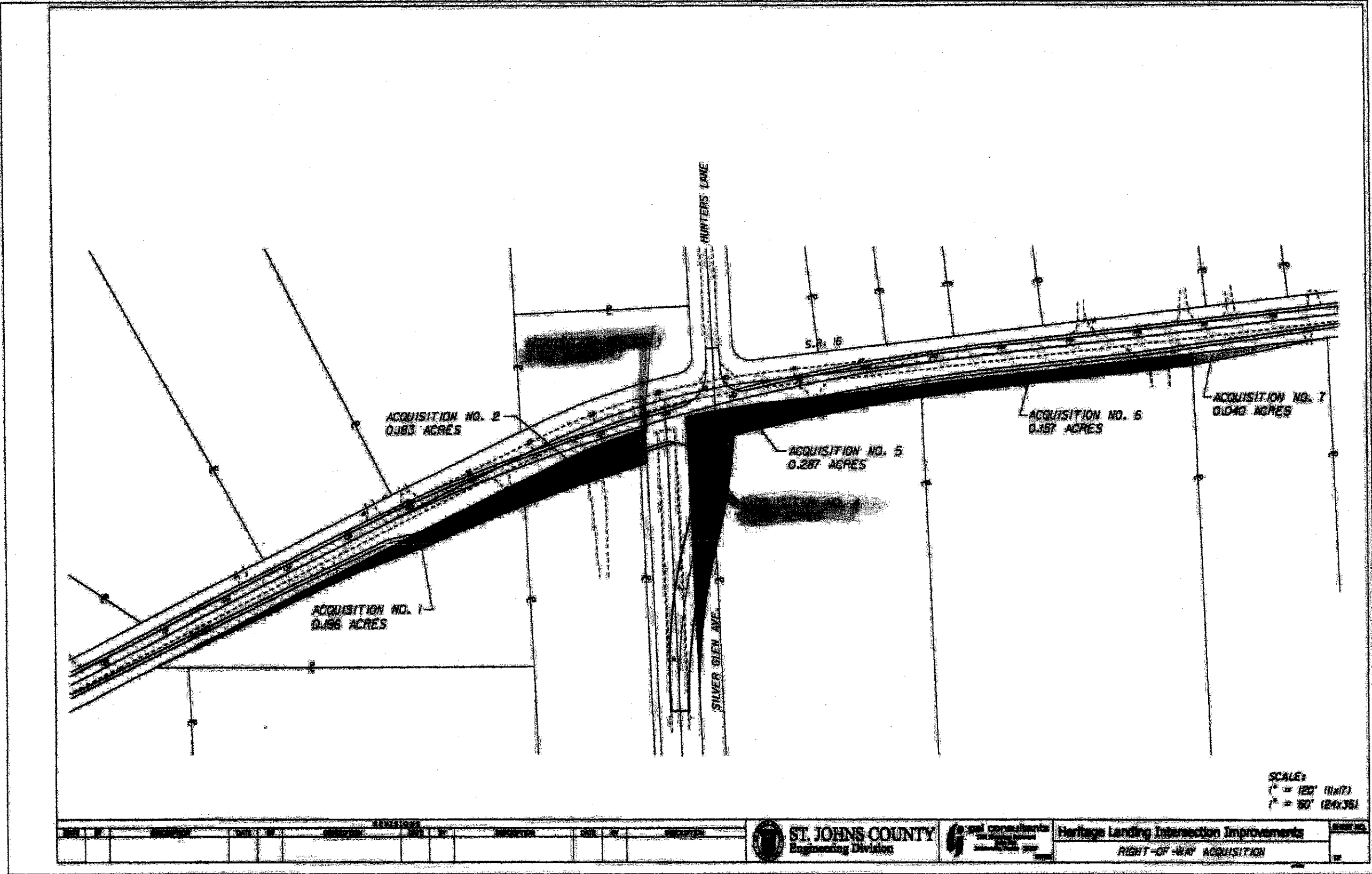

NO.	DATE	DESCRIPTION	BY	CHECKED	DATE	DESCRIPTION

ST. JOHNS COUNTY
 Engineering Division



Heritage Landing Intersection Improvements
 RIGHT-OF-WAY ACQUISITION

SHEET NO. 12